

SCHEDULE OF WINDOW MASONRY OPENING						SCHEDULE OF DOORS			
TYPE	WIDTH	HEIGHT	SILL HT.	LINTEL HT.	REMARKS	TYPE	MASONRY OPENING WIDTH	HEIGHT	REMARKS
W1	3000	2250	450	2700		D	1200	2400	
W2	2500	2250	450	2700		D1	1100	2400	
W3	2000	2250	450	2700		D2	900	2400	KITCHEN
W4	1500	2250	450	2700		D3	750	2400	TOILET
W5	1200	2250	450	2700		D4	1000	2400	
W6	1000	1000	1100	2700	KITCHEN	D5	600	2400	
W7	600	1000	1700	2700	TOILET	D6	2500	2400	
W8	2500	2250	450	2700		FCD	1000	2400	
WS	VARIES				STAIR	RS	1500	2700	
V1	1000	1000			H.T. & L.T ROOM	RS1	4000	2700	
V2	1200	1000			TOILET	DW1	1825	2400	
						DW2	1850	2400	
						SD	VARIES	2400	
						D2V	900	3400	TOILET

For and behalf of:  
Rutt Deen Pvt. Ltd.  
Cheksons Broking Co. Pvt. Ltd.  
Techmart Broking CO. Pvt. Ltd.

For and on behalf of:  
Rutt Deen Pvt. Ltd.  
Cheksons Broking Co. Pvt. Ltd.  
Techmart Broking Co. Pvt. Ltd.  
*Dileep Singh Mehta*  
Dileep Singh Mehta  
Designated Partner - Loudon Developers LLP  
Constituted Attorney

**DILEEP SINGH MEHTA**  
Designated Partner-Loudon Developers LLP  
Constituted Attorney  
SIGNATURE OF OWNER

*Saugata Mitra*  
**SAUGATA MITTRA**  
B. ARCH., AIA  
CA/2002/29849  
SIGNATURE OF ARCHITECT

**SAUGATA MITTRA**  
REG. NO.- CA/2002/29849

**CERTIFICATE OF STRUCTURAL STABILITY**  
I HEREBY THAT THE FOUNDATION AND SUPERSTRUCTURE OF THE BUILDING PROPOSED FOR CONSTRUCTION ON PREMISES NO.- 21B, DR. U.N. BRAHMACHARI STREET, WARD NO.- 63, BOROUGH NO.- VII, UNDER KOLKATA MUNICIPAL CORPORATION, HAVE BEEN SO DESIGNED BY ME WILL MAKE SUCH FOUNDATION AND SUPER STRUCTURE SAFE IN ALL RESPECT INCLUDING THE CONSIDERATION OF BEARING CAPACITY OF SOIL ETC.

*Bibek Bikash Mullick*  
**BIBEK BIKASH MULLICK**  
E. S. E. - 1/75  
KOLKATA MUNICIPAL CORPORATION  
SIGNATURE OF STRUCTURAL ENGINEER  
**BIBEK BIKASH MULLICK**  
118/2B BHUBAN MOHAN ROY ROAD  
KOLKATA-700 00B  
EMPANELMENT NO.- ESE-1/75

*Kaushik Sengupta*  
**KOUSHIK SENGUPTA**  
B.E.(CIVIL), M.E.(STRUCTURE)  
STRUCTURAL REVIEWER (K.M.C.)  
B.S.R.-1/76/5  
SIGNATURE OF STRUCTURAL REVIEWER  
**KAUSHIK SENGUPTA**  
EMPANELMENT NO.- ESR-1/76/5

*J.N. Ghosh*  
**J. N. GHOSH**  
ME (Geo-technical Engg.)  
BCE, Chartered Engineer  
Fellow (I.E.I.), F.I.V.  
Consulting Engineer & Valuer  
(G.T/1/4)  
SIGNATURE OF GEO-TECHNICAL ENGINEER  
**J. N. GHOSH**  
37B, HINDUSTAN ROAD,  
FIRST FLOOR, KOLKATA-700 029

**PROJECT TITLE:-**  
**PROPOSED ADDITION TWO ADDITIONAL FLOOR AND ALTERATION TO B+G+21 STORIED ( HT. : 79.8 M ) RESIDENTIAL BUILDING AT PREMISES NO.- 21B, DR. U.N. BRAHMACHARI STREET, WARD NO.- 63, BOROUGH NO.- VII, KOLKATA- 700016.**  
**B.P. NO. :- 2015070096 , DATED :- 15. OCT. 2015**

**21TH FLOOR PLAN ; ROOF PLAN**  
**PROJECT ARCHITECT:-**  
**CONSULTANTS FOR HUMAN SETTLEMENT**  
**SHELTER**  
Flat no.-38, 7th Floor, Kohinoor Building,  
105 park street, Kolkata-16.  
Tel. : + 91-33 - 2265 - 1263 / 64 ,  
E-mail : saugata.shelter@gmail.com  
164/B, Becharam Chatterjee Street, Kolkata-700061.  
566 Anna Salai, Teynampet, Chennai-600018.

DEALT BY: S. Chowdhury  
SCALE : 1:100  
DATE : 01.01.2016  
DRG. NO. : 21B,DR.UNBR/KMC/ARCH/RS-10

**SPACE FOR OFFICE USE**

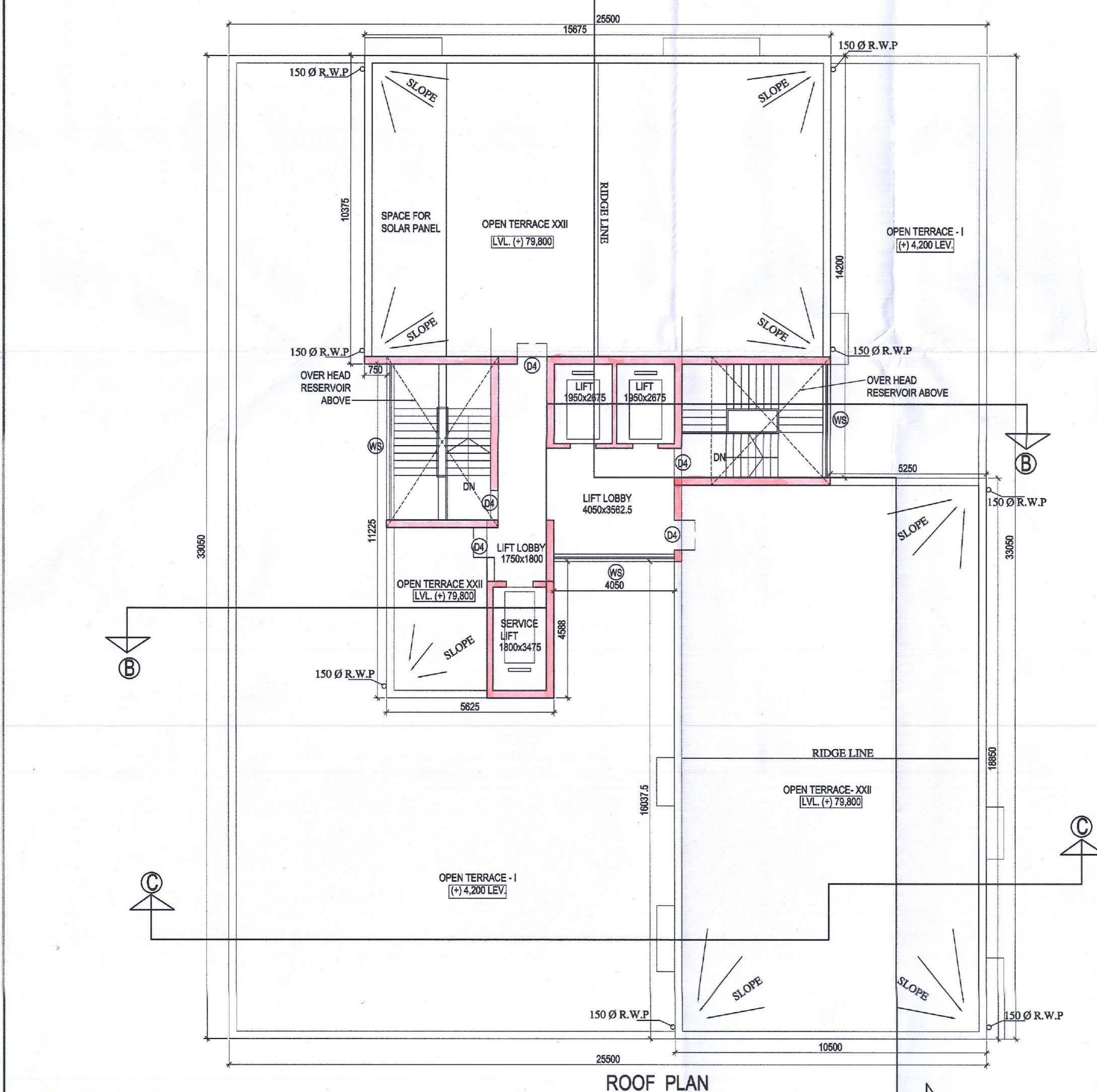

**LEGEND :**

. SANCTIONED TO BE CONSTRUCTED - YELLOW FIRM	
. SANCTIONED NOT TO BE CONSTRUCTED - YELLOW HATCHED	
. PROPOSED TO BE CONSTRUCTED - RED FIRM	